

MODEL 3109-3CCT | 3112-3CCT | 3116-3CCT



HIGHLIGHTS

3 CCT selectable 9" (3109-3CCT) / 12" (3112-3CCT) / 16" (3116-3CCT) LED frameless ceiling mounts

- Rotatable and extremely easy installation
- Good quality LGP (Light Guided Plate) and diffuser plate
- Stable design for whole structure ensures uniform lighting, no black dots or shadow

SPECIFICATIONS

Model	3109-3CCT	3112-3CCT	3116-3CCT
Wattage	20W	25W	30W
Voltage	120V AC	120V AC	120V AC
Lumens	1600 lmn	2000 lmn	2400 lmn
Beam Angle	120°	120°	120°
Lifetime	50000 hours	50000 hours	50000 hours
CRI	80	80	80
Dimmable	Yes	Yes	Yes
Rating	Non-IC Rated / Indoor use / for Damp location		
Grade of Protection	IP 20	IP 20	IP 20
Applications	Corridors / Lobbies / Kitchens / Bedrooms / Bathrooms		
Colour Temp.	3000K (Warm White) / 4000K (Natural White) / 5000K (Cool White)		
Operating Temp.	-20°C ~ +40°C		
Warranty	5 years		

EXPANSION FUNCTION



3CCT Changeable

Changeable 3000K/4000K/5000K controlled by 3CCT switch

3000K (Warm White)



4000K (Natural White)



5000K (Cool White)



TESTING REPORT & DIMENSIONS

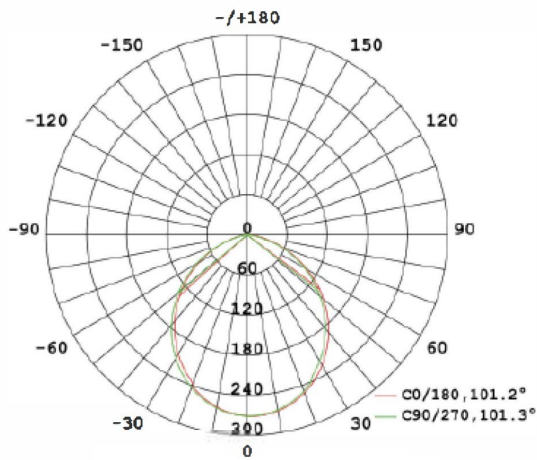

Light Distribution Curve

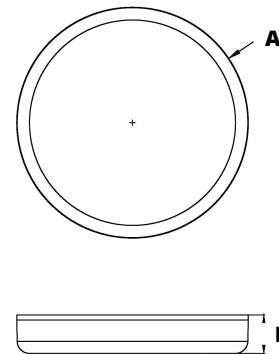

3109-3CCT

- A** Ø 8-7/8" (225mm)
- B** 1-1/2" (38mm)

3112-3CCT

- Ø 11-1/2" (293mm)
- 1-1/2" (38mm)

3116-3CCT

- Ø 15-5/8" (397mm)
- 1-1/2" (38mm)

Reference	QTY.	Remarks	Project:
			Location:
			Architect:
			Engineer:
			Contractor:
			Submitted by:
			Date:

ORTECH reserves the right to modify at any time, without notice, any or all of our product's features, designs, components and specifications to meet market changes.