



WARNING

WARNING — THE INSTALLATION MUST BE CARRIED OUT BY A QUALIFIED ELECTRICIAN.

1. LED UFO High Bays must be grounded
2. Please keep the LED UFO High Bays away from any corrosive substance, and please use dry or wet cloth when you clean it
3. LED UFO High Bays can only be installed by a qualified electrician
4. Before installation or maintenance, please disconnect the power to prevent electric shock
5. Always keep the lens/diffuser of the LED UFO High Bay cleaned to maintain good light transmission
6. At all times, keep the shell of the LED UFO High Bay cleaned to retain good heat dissipation

CAUTION

PLEASE READ INSTRUCTION BEFORE COMMENCING INSTALLATION AND RETAIN FOR FUTURE REFERENCES.

Electrical products can cause death or injury, or damage to property.

If in any doubt about the installation or use of this product, consult a competent electrician.

INSTALLATION GUIDE

Rings type Installation

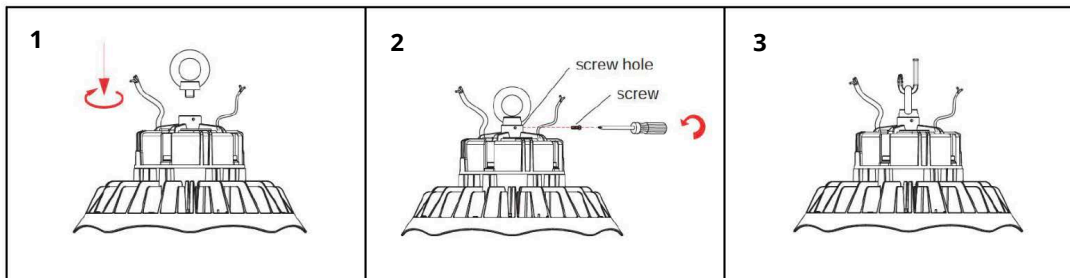

1. Lock the ring. (see pic.1)
2. Tighten the screw.
(This step can be omitted if there is no screw hole. See pic.2)
3. Hang up the light.
(see pic.3)

Hook type Installation

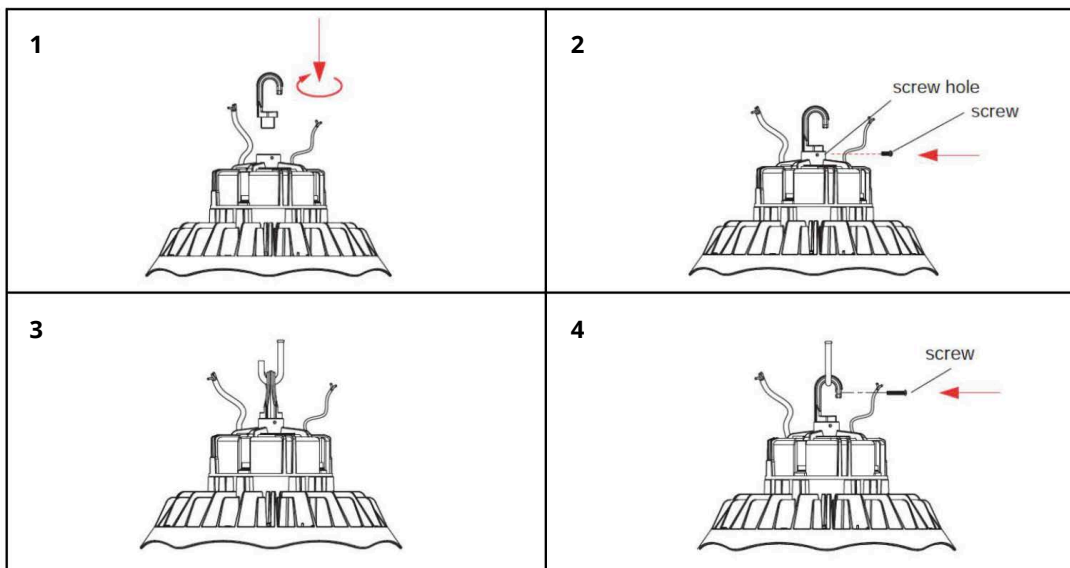

1. Lock the hook. (see pic.1)
2. Tighten the screw.
(This step can be omitted if there is no screw hole. See pic.2)
3. Hang up the light. (see pic.3)
4. Lock the screw. (see pic.4)

ORTECH reserves the right to modify at any time, without notice, any or all of our product's features, designs, components and specifications to meet market changes.