

## MODEL 2400-3CCT



### WARNING

**WARNING — THE INSTALLATION MUST BE CARRIED OUT BY A QUALIFIED ELECTRICIAN.**

1. LED Flush Mounts are suitable for using in damp locations
2. Please keep the LED Flush Mounts away from any corrosive substance, and please use dry cloth when you clean it
3. LED Flush Mounts can only be installed by a qualified electrician
4. Before installation or maintenance, please disconnect the power to prevent electric shock

### Application Notice

1. RISK OF SHOCK — House electric current can cause painful shock or serious injury unless handled properly. For your safety, always remember to:
  - A) Turn OFF the power supply at the fuse or circuit breaker box before you install the fixture
  - B) Double-check all connections to be sure that they are tight and correct
2. This fixture is designed for use in a circuit protected by a fuse or circuit breaker. It is also designed to be installed in accordance with local electrical codes. If you are unsure about your wiring, consult a qualified electrician or local electrical inspector, and check your local electrical code
3. RISK OF CUTS — some metal parts in the fixture may have sharp edges. To prevent cuts and scrapes, wear gloves when handling the parts
4. Account for small parts and destroy packing material, as these may be hazardous to children
5. The light source contained in this luminaire shall only be replaced by the manufacturer or his service agent or a similar qualified person
6. Terminal block and the suspending accessories are not included. Installation must be performed by a qualified person

### CAUTION

**PLEASE READ INSTRUCTION BEFORE COMMENCING INSTALLATION AND RETAIN FOR FUTURE REFERENCES.**

**Electrical products can cause death or injury, or damage to property.**

**If in any doubt about the installation or use of this product, consult a competent electrician.**

## INSTALLATION GUIDE

### Surface Mount Installation

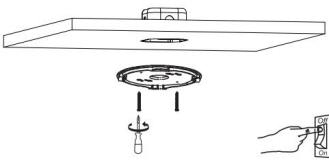

- 1) Turn off the switch.  
Screw the bracket to the junction box and ceiling

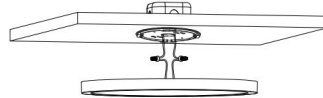

- 2) Connect the lamp body wires with power cord

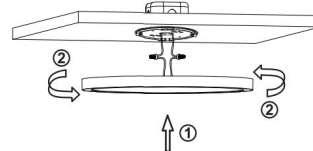

- 3) Push the lamp towards the ceiling and rotate the lamp to make the mounting plate and the lamp body fixed tightly

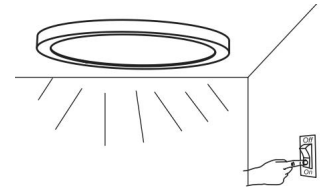

- 4) Turn on the switch to check if the lamp works normally

### Semi-flush Mount Installation

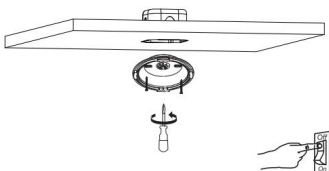

- 1) Turn off the switch.  
Screw the semi-flush mounted bracket to the junction box and ceiling

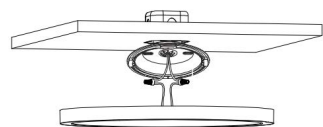

- 2) Connect the lamp body wires with power cord

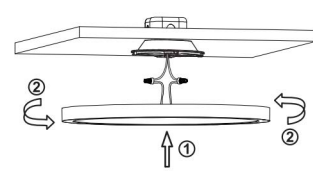

- 3) Push the lamp towards the ceiling and rotate the lamp to make the mounting plate and the lamp body fixed tightly

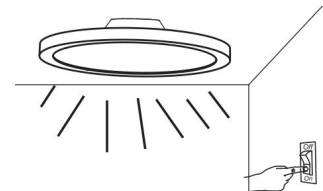

- 4) Turn on the switch to check if the lamp works normally

### **IMPORTANT REMINDER**

Please obey fire prevention regulations. **DO NOT** cover the fixture with any heat insulated materials. **DO NOT** change the LED light source or driver inside under any circumstance.

ORTECH reserves the right to modify at any time, without notice, any or all of our product's features, designs, components and specifications to meet market changes.