

LED UFO High Bays

MODEL UFO-150-3CCT+W | UFO-240-3CCT+W

ORTECH

Product Specification Sheet



HIGHLIGHTS

Watts and CCT Selectable UFO High Bay

- Simple and stylish appearance
- Excellent heat dissipation
- DLC 5.1 Premium with high luminous efficacy and low UGR
- PnP sensor option
- Round EM driver for fast installation
- Complete selection of accessories available
- 3CCT (3500K-4000K-5000K)
- It is made of PC and the lighting angle is 110°
- Mounting options: hook/chain (included in packaging)

SPECIFICATIONS

Model	UFO-150-3CCT+W	UFO-240-3CCT+W
Wattage	100W/125W/150W	150W/200W/240W
Voltage	AC 120-347V	
Beam Angle	110°	
Lifetime	≥50000 hours	
Lighting Efficiency	135LM/W	
CRI	Ra>80	
Location	Wet Location	
Colour Temp.	3500K 4000K 5000K	
Lumens	20,250lmn	32,400lmn
Operating Temp.	-40°C~45°C	
Grade of Protection	IP 65	
Dimmable	Yes(only 0-10v dimming available)	
Warranty	5 years	

DIMENSIONS

UFO-150-3CCT+W

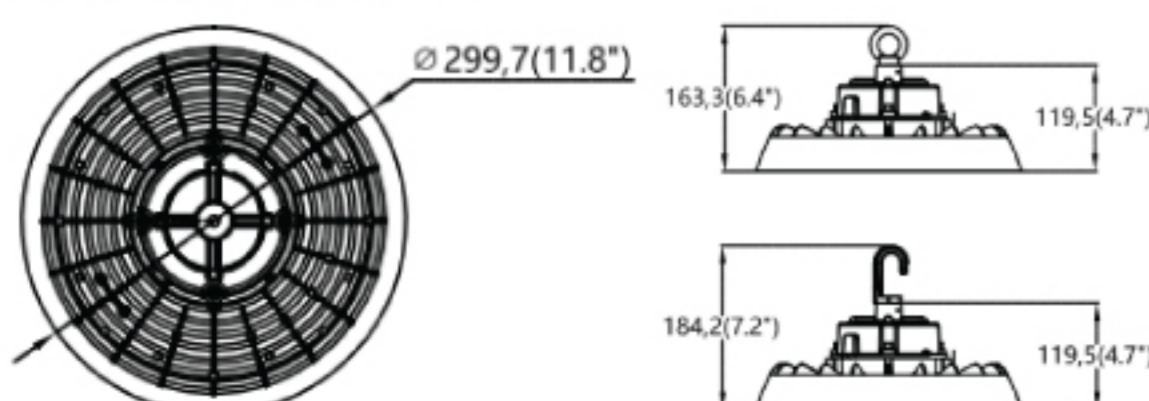

UFO-240-3CCT+W

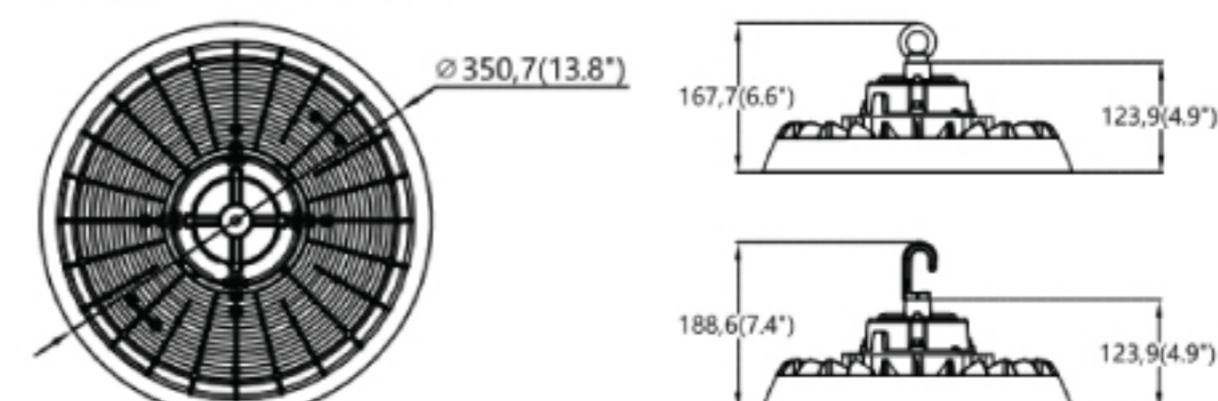

LED UFO High Bays

MODEL UFO-150-3CCT+W | UFO-240-3CCT+W



Product Specification Sheet

WATTS & CCT SELECTABLE

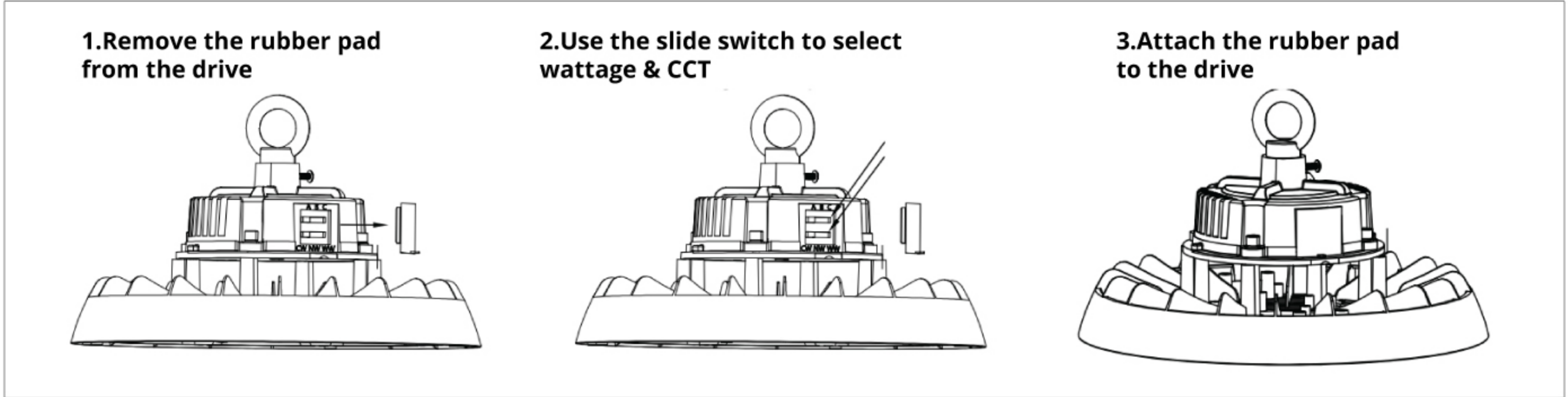

INSTALLATION

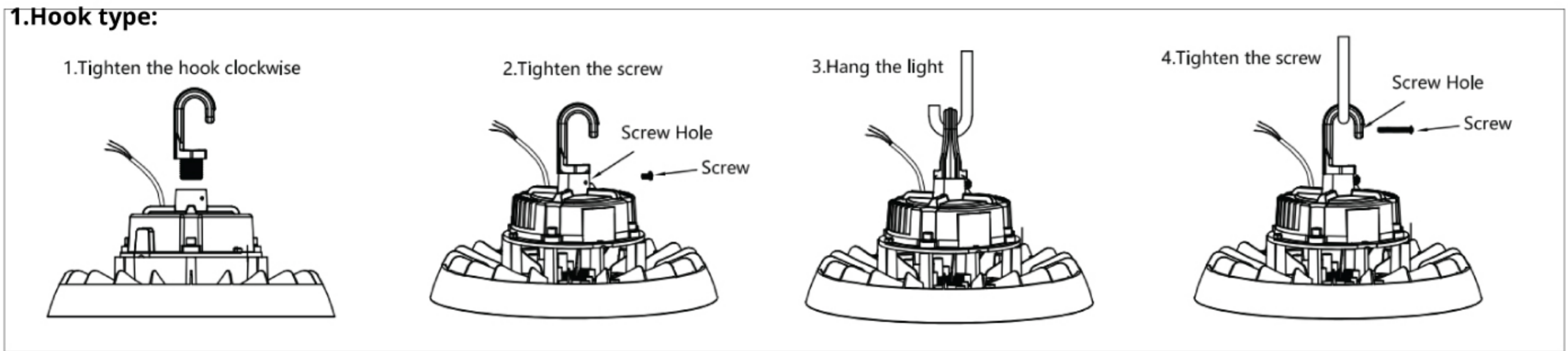

OPTIONAL ACCESSORY (SOLD SEPARATELY)

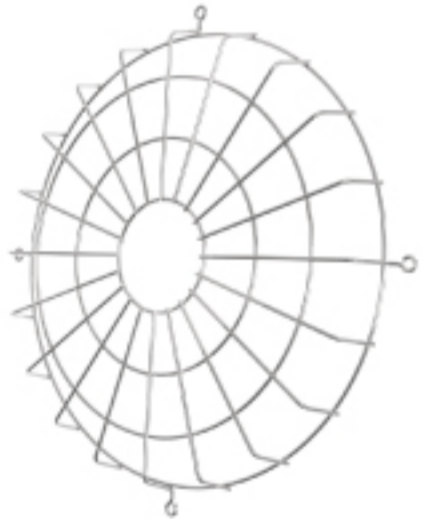

WIRE GUARD



PNP-SENSOR



PNP-REMOTE



ALUMINUM REFLECTOR

Reference	QTY.	Remarks	Project:
			Location:
			Architect:
			Engineer:
			Contractor:
			Submitted by:
			Date:

ORTECH reserves the right to modify at any time, without notice, any or all of our product's features, designs, components and specifications to meet market changes.