

MODEL PLATE 72-C6



HIGHLIGHTS

- Formerly LD-5K
- 4-11/16" x 4-11/16"
- 4-11/16" square cover 1/2" KO
- Square 1/2" knock out cover for boxes

SPECIFICATIONS

Model	PLATE 72-C6
Size	4-11/16" x 4-11/16"
Material	Galvanized steel
Knockouts	None
Case Quantities	200

DIMENSIONS

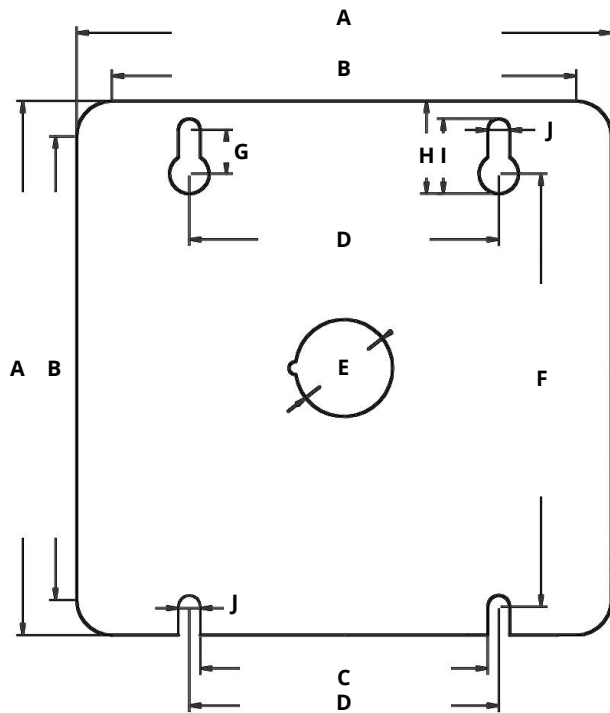

Model	PLATE 72-C6
A	4-3/4" (121mm)
B	4-1/8" (105mm)
C	2-9/16" (65mm)
D	2-3/4" (70mm)
E	7/8" (22mm)
F	3-7/8" (98mm)
G	3/8" (10mm)
H	13/16" (21mm)
I	11/16" (17mm)
J	3/16" (5mm)

Reference	QTY.	Remarks	Project:
			Location:
			Architect:
			Engineer:
			Contractor:
			Submitted by:
			Date:

ORTECH reserves the right to modify at any time, without notice, any or all of our product's features, designs, components and specifications to meet market changes.