

## MOUNTING PLATES

### PLATE26-3A

### HIGHLIGHTS

**New Construction Plate made up of galvanized steel for recessed lighting**

- Includes holes for easy installation
- Compatible with **ORTECH 3" LED Slim Lights** - (SLIM-RG3-5CCT, SLIM-RG4-5CCT)



### SPECIFICATIONS

| MODEL      | HOLE SIZE         | MATERIAL         | COMPATIBLE LIGHTS  |
|------------|-------------------|------------------|--|
| PLATE26-1  | Ø2-1/8" (54mm)    | Galvanized Steel | ORTECH 1" LED Slim Lights - (SLIM-RG1-5CCT)  |
| PLATE26-2  | Ø2-19/32" (66mm)  |                  | ORTECH 2" LED Slim Lights - (SLIM-RG2-5CCT, SLIM-TL2-5CCT)   |
| PLATE26-3  | Ø2-61/64" (75mm)  |                  | ORTECH 3" LED Slim Lights - (DISC-RG3, SLIM3CONT-3CCT, SLIM3CONT-WH, SLIM3GIM-5CCT)  |
| PLATE26-3A | Ø3-15/32" (88mm)  |                  | ORTECH 3" LED Slim Lights - (SLIM-RG3-5CCT, SLIM-RG4-5CCT)   |
| PLATE26-4  | Ø4-9/64" (105mm)  |                  | ORTECH 4" LED Slim Lights - (DISC4-3CCT, DISC4FL-GM-WH, OLT2-410-5CCTWH, OLT2-412-WH, SLIM4-3CCT, SLIM4BP-5CCT, SLIM4CONT-3CCT, SLIM4DGF-5CCT, SLIM4DGR-5CCT, SLIM4DR-5CCT, SLIM4GIM, SLIM4GIM-5CCT, SLIM4ID-WH, SLIM4RG)  |
| PLATE26-4A | Ø4-1/4" (108mm)   |                  | ORTECH 4" LED Slim Lights - (DISC4-3CCT, DISC4FL-GM-WH, OLT2-410-5CCTWH, OLT2-412-WH, SLIM4-3CCT, SLIM4BP-5CCT, SLIM4CONT-3CCT, SLIM4DGF-5CCT, SLIM4DGR-5CCT, SLIM4DR-5CCT, SLIM4GIM, SLIM4GIM-5CCT, SLIM4ID-WH, SLIM4RG, SLIM4HE-3CCT, SLIM4-5CCT, SLIM4FR-5CCT, SLIM4FR+FL-5CCT) |
| PLATE26-6  | Ø6-17/64" (159mm) |                  | ORTECH 6" LED Slim Lights - (OLT2-615-5CCTWH, SLIM6-3CCT, SLIM6ID-WH)  |

### DIMENSIONS

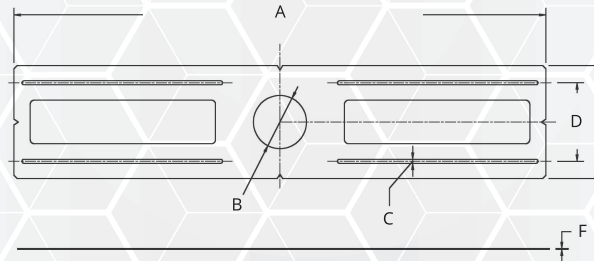

| Model | PLATE26-1          | PLATE26-2         | PLATE26-3          | PLATE26-3A        | PLATE26-4         | PLATE26-4A       | PLATE26-6          |
|-------|--------------------|-------------------|--------------------|-------------------|-------------------|------------------|--------------------|
| A     | 25-63/64" (660mm)  |                   |                    |                   |                   |                  |                    |
| B     | Ø2-1/8" (54mm)     | Ø 2-19/32" (66mm) | Ø 2-61/64" (75mm)  | Ø 3-15/32" (88mm) | Ø 4-9/64" (105mm) | Ø 4-1/4" (108mm) | Ø 6-17/64" (159mm) |
| C     | 13/64" (5mm)       |                   |                    |                   |                   |                  |                    |
| D     | Ø 3-13/16" (97mm)  |                   | Ø 4-1/2" (114.2mm) |                   |                   |                  | Ø 6-17/32" (166mm) |
| E     | Ø 5-33/64" (140mm) |                   | Ø 6-3/16" (157mm)  |                   |                   |                  | Ø 8-17/64" (210mm) |
| F     | 1/32" (0.8mm)      |                   |                    |                   |                   |                  |                    |

### COMPATIBLE PRODUCTS

#### SLIM-RG3-5CCT, SLIM-RG4-5CCT

| Reference | QTY. | Remarks | Project:      |
|-----------|------|---------|---------------|
|           |      |         | Location:     |
|           |      |         | Architect:    |
|           |      |         | Engineer:     |
|           |      |         | Contractor:   |
|           |      |         | Submitted by: |
|           |      |         | Date:         |

ORTECH reserves the right to modify at any time, without notice, any or all of our product's features, designs, components and specifications to meet market changes.