

MOUNTING PLATES

PLATE26-1

HIGHLIGHTS

New Construction Plate made up of galvanized steel for recessed lighting



- Includes holes for easy installation
- Compatible with all **ORTECH 1" Slim Lights** - (SLIM-RG1-5CCT)

SPECIFICATIONS

MODEL	HOLE SIZE	MATERIAL	COMPATIBLE LIGHTS
PLATE26-1	Ø2-1/8" (54mm)	Galvanized Steel	ORTECH 1" LED Slim Lights - (SLIM-RG1-5CCT)
PLATE26-2	Ø2-19/32" (66mm)		ORTECH 2" LED Slim Lights - (SLIM-RG2-5CCT, SLIM-TL2-5CCT)
PLATE26-3	Ø2-61/64" (75mm)		ORTECH 3" LED Slim Lights - (DISC-RG3, SLIM3CONT-3CCT, SLIM3CONT-WH, SLIM3GIM-5CCT)
PLATE26-3A	Ø3-15/32" (88mm)		ORTECH 3" LED Slim Lights - (SLIM-RG3-5CCT, SLIM-RG4-5CCT)
PLATE26-4	Ø4-9/64" (105mm)		ORTECH 4" LED Slim Lights - (DISC4-3CCT, DISC4FL-GM-WH, OLT2-410-5CCTWH, OLT2-412-WH, SLIM4-3CCT, SLIM4BP-5CCT, SLIM4CONT-3CCT, SLIM4DGF-5CCT, SLIM4DGR-5CCT, SLIM4DR-5CCT, SLIM4GIM, SLIM4GIM-5CCT, SLIM4ID-WH, SLIM4RG)
PLATE26-4A	Ø4-1/4" (108mm)		ORTECH 4" LED Slim Lights - (DISC4-3CCT, DISC4FL-GM-WH, OLT2-410-5CCTWH, OLT2-412-WH, SLIM4-3CCT, SLIM4BP-5CCT, SLIM4CONT-3CCT, SLIM4DGF-5CCT, SLIM4DGR-5CCT, SLIM4DR-5CCT, SLIM4GIM, SLIM4GIM-5CCT, SLIM4ID-WH, SLIM4RG, SLIM4HE-3CCT, SLIM4-5CCT, SLIM4FR-5CCT, SLIM4FR+FL-5CCT)
PLATE26-6	Ø6-17/64" (159mm)		ORTECH 6" LED Slim Lights - (OLT2-615-5CCTWH, SLIM6-3CCT, SLIM6ID-WH)

DIMENSIONS

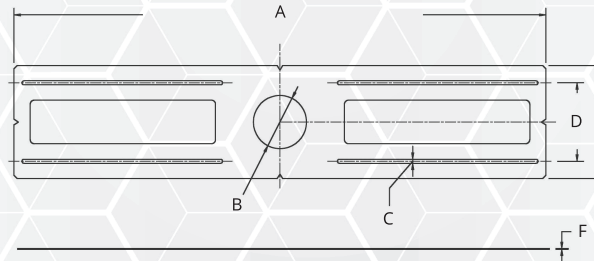

Model	PLATE26-1	PLATE26-2	PLATE26-3	PLATE26-3A	PLATE26-4	PLATE26-4A	PLATE26-6
A	25-63/64" (660mm)						
B	Ø2-1/8" (54mm)	Ø 2-19/32" (66mm)	Ø 2-61/64" (75mm)	Ø 3-15/32" (88mm)	Ø 4-9/64" (105mm)	Ø 4-1/4" (108mm)	Ø 6-17/64" (159mm)
C	13/64" (5mm)						
D	Ø 3-13/16" (97mm)		Ø 4-1/2" (114.2mm)				Ø 6-17/32" (166mm)
E	Ø 5-33/64" (140mm)		Ø 6-3/16" (157mm)				Ø 8-17/64" (210mm)
F	1/32" (0.8mm)						

COMPATIBLE PRODUCTS

SLIM-RG1-5CCT

Reference	QTY.	Remarks	Project:
			Location:
			Architect:
			Engineer:
			Contractor:
			Submitted by:
			Date:

ORTECH reserves the right to modify at any time, without notice, any or all of our product's features, designs, components and specifications to meet market changes.